

# 2-Ton Gantry Boat

W6x15 Galv.  
Steel Gantry  
Frame

6' x 4' open  
style pilot cab

2-Ton 12VDC  
Hoist and  
Trolley

36" diameter pontoons  
with integrated transom  
on centre pontoon

4 Bollards

28' x 16' Deck with  
3/16" aluminum  
tread plate

4" hat bars  
12" on centre

40" Railing,  
gates/openings  
to suit

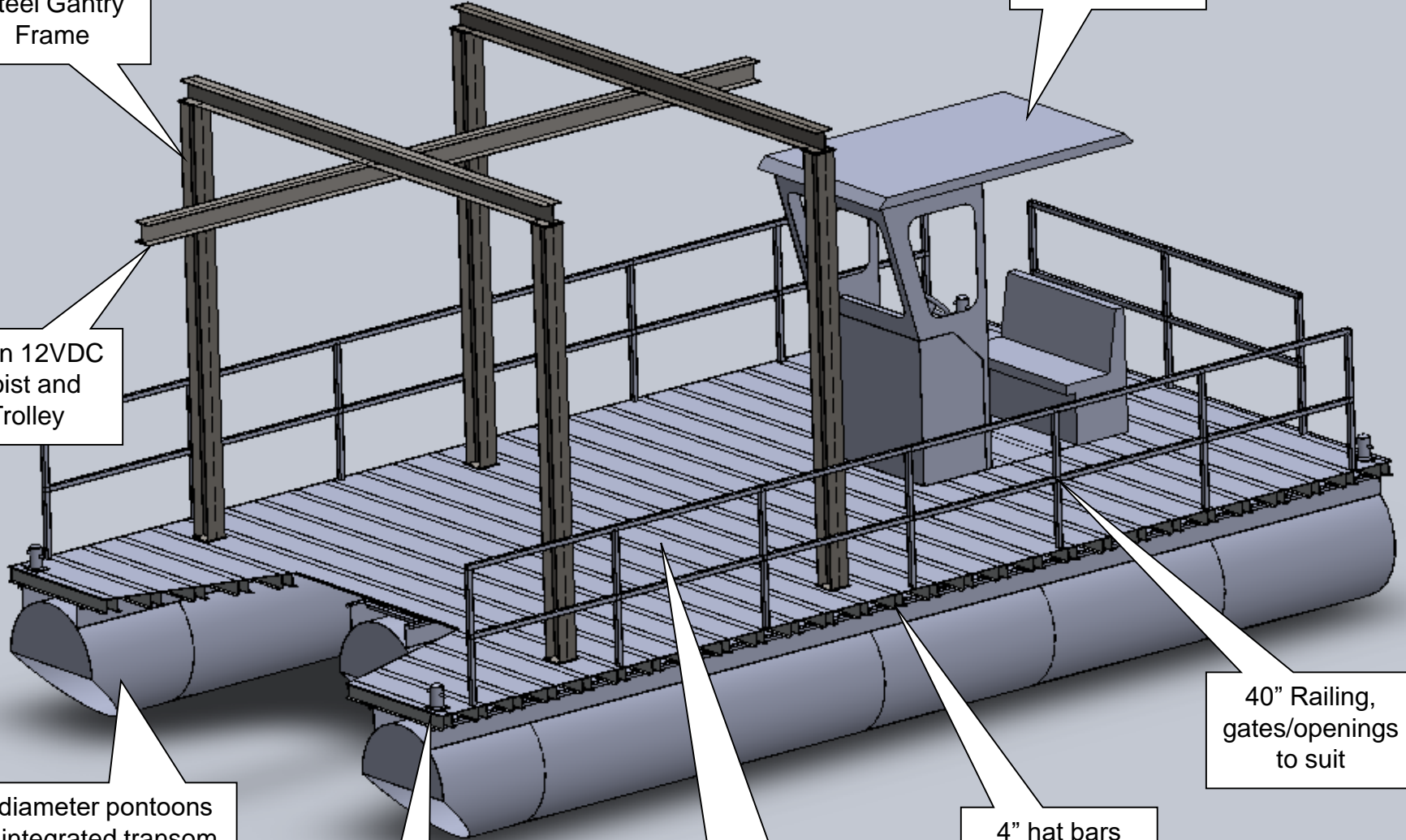

# 2-Ton Gantry Boat

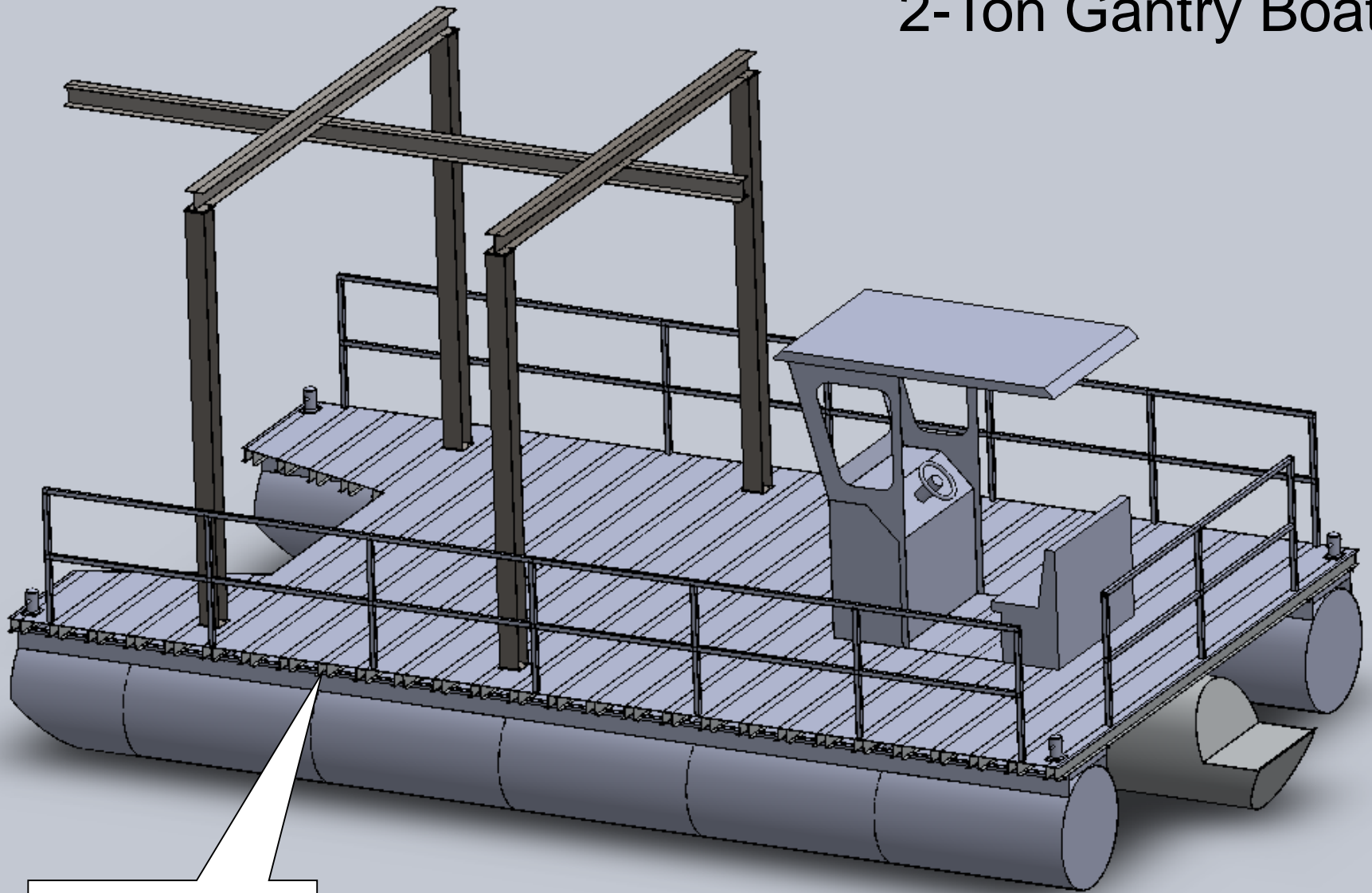

Edge capping all  
around deck and 2-ton  
hoist not shown

# 2-Ton Gantry Boat

